

Direct robot control from G-code

- The "TwinCAT3 NC I" G-code scanning function can be used to directly control robots from G-code, a language supported by a wide variety of CAD/CAM software, significantly reducing teaching and programming work.

Use G-code to control robots

G-code can be used to control robots, without the need to use specialized robot language.

Significantly reduce time spent adjusting for applications that require complicated trajectories, such as applying sealant.

Conventional method

Requires more work teaching the many waypoints along the paths following the differing shapes of products, and then programming to connect these points.



Control using G-code

Based on CAD drawings, use the CAD/CAM software to create the tool path offline, and then output G-code.

TwinCAT inside the robot controller can process G-code and control the robot arm directly, eliminating the need to register waypoints and significantly decreasing adjustment work.

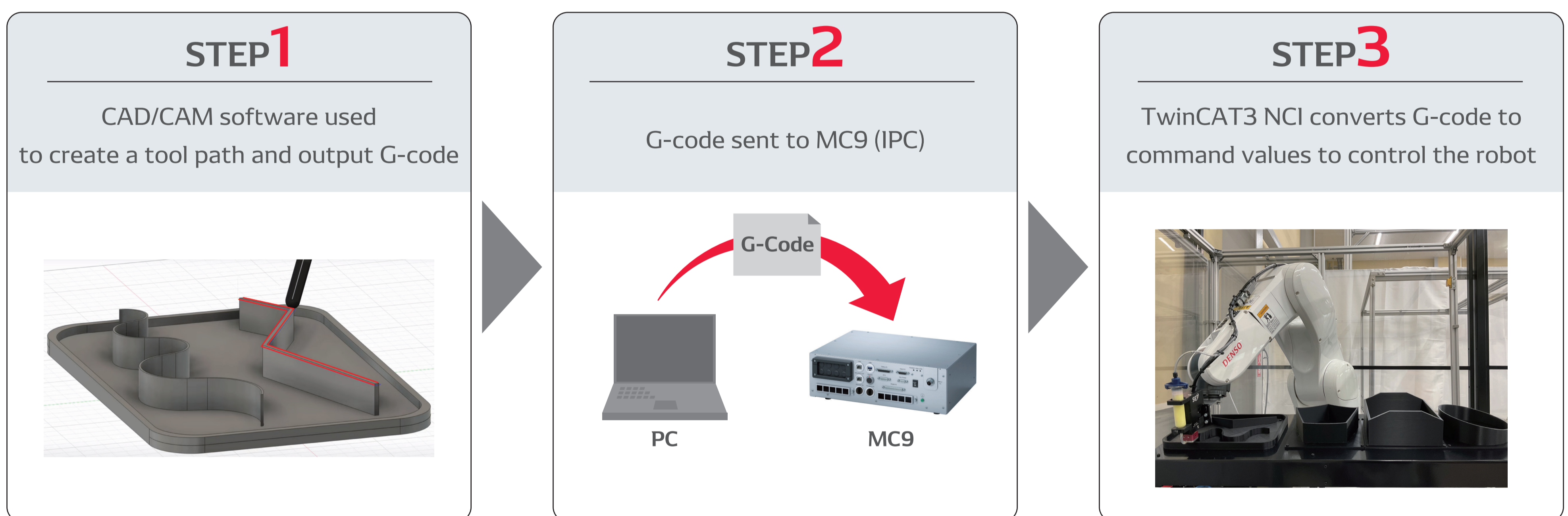

Possible applications

Applying sealant, applying adhesive, burring, grinding, etc.

System configuration

